

# NH 창원가포 A-2BL 주방가구

## 본납도면

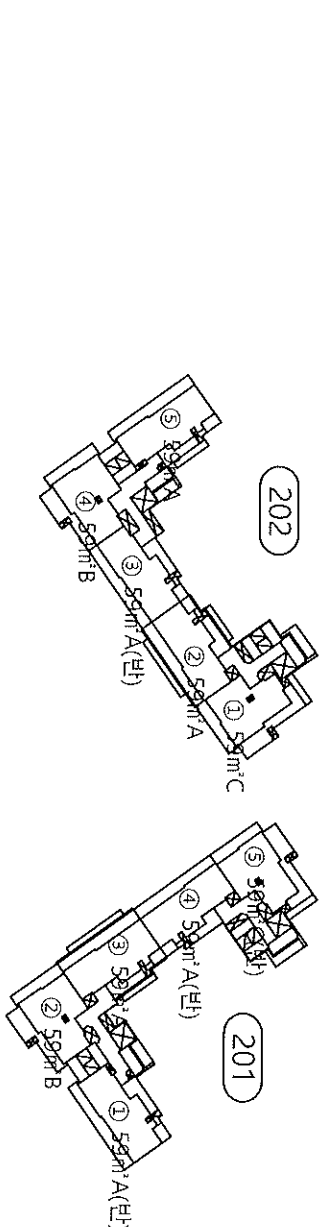

- DATE. 2022. 08. 26

- 59㎡A형 202동203호(도면반대)

- 59㎡B형 202동204호(도면동일)

- 59㎡C형 202동201호(도면동일)

- 경상남도 창원시 마산합포구 가포동 788

구분	도면	반대	계
- 59㎡A	126	110	236
- 59㎡B	56	20	76
- 59㎡C	54	36	90
계			402

승인			내관장

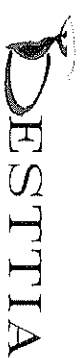

서울시 영등포구 당산로 41길 11 702호(SK V1 CENTER)

대표전화: (02) 790-0381 FAX: (02) 790-0391



CONSTRUCTION



PROJECT: LH 창원기포 A-2BL

AREA TITLE: 59표A형 단위세대

ITEM TITLE: 주방기포

NOTE

제대: LH LPL-002

상부장기 큰장 문책: SM-306MT

하부장기 문책: PET(SM-224MT)

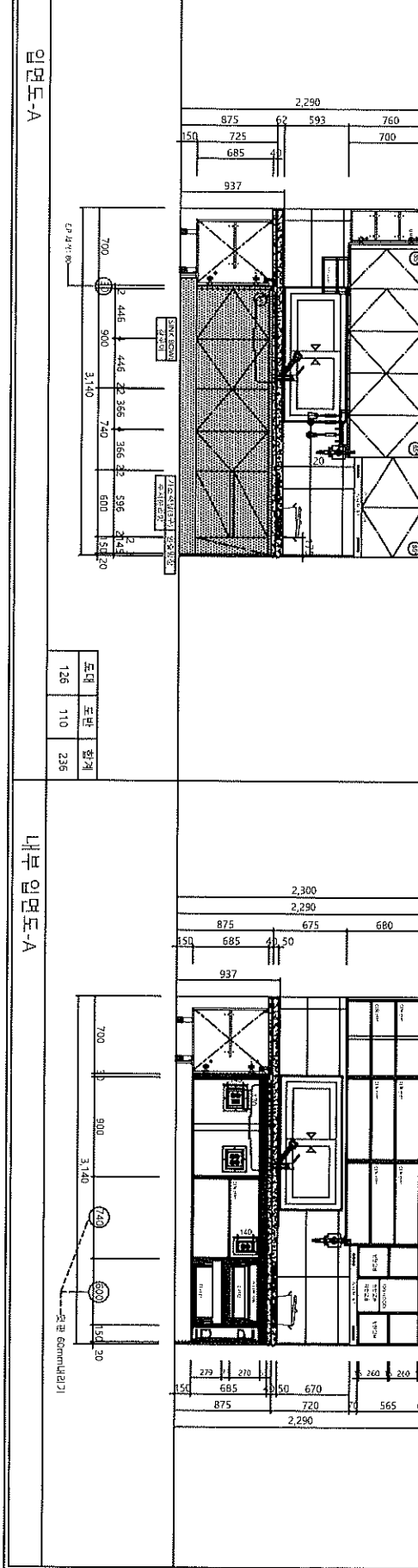
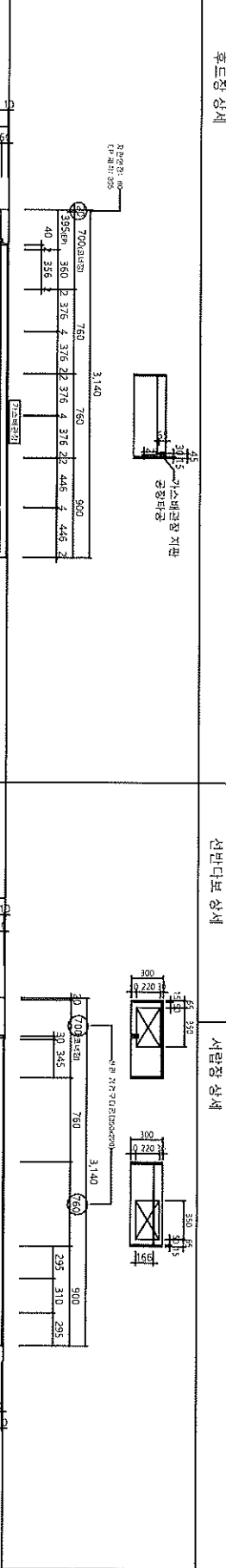
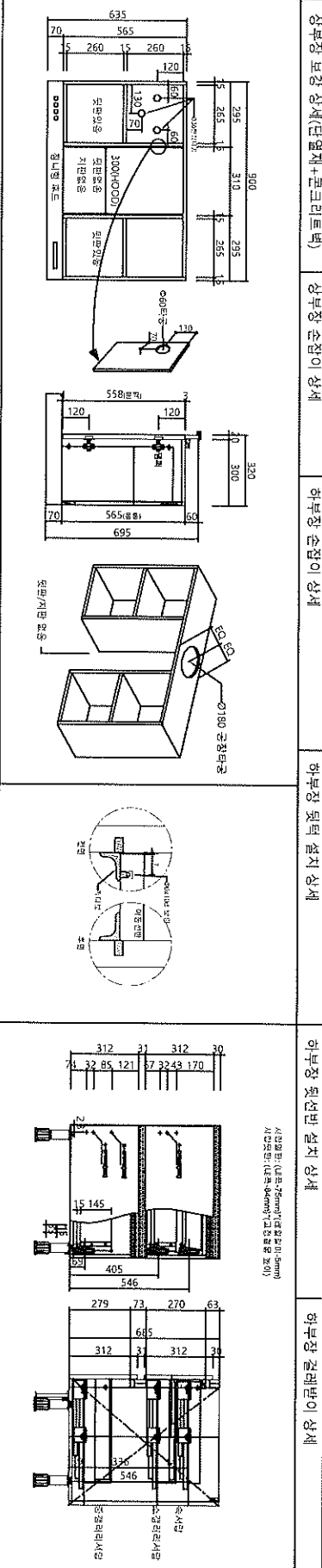
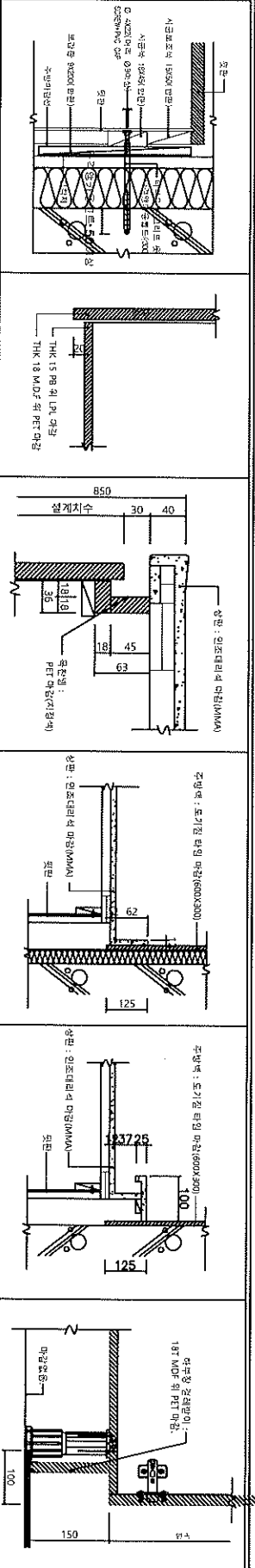

DESTTIA 베스티아주식회사

서울시 용문로 58(송파구 송파동 2113) 1511호 (용문역 5분거리)

TEL 02790-0381 / FAX 02790-0351

PROJECT NO: 2022\_08\_28

DATE: 2022. 08. 28

SCALE: 1/10

DATE: 2022. 08. 28

SCALE: 1/10

CONSTRUCTION:



PROJECT: LH 창원기포 A-2BL

AREA TITLE

59㎡A형 단위세대

ITEM TITLE

주방기구

NOTE

체대: LH LPL-002

상부장기판장 문막: SM-306MT

하부장 문막: PET(SM-224MT)

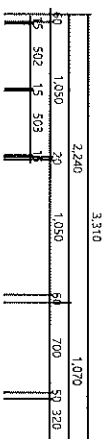

3.310

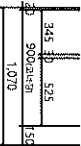
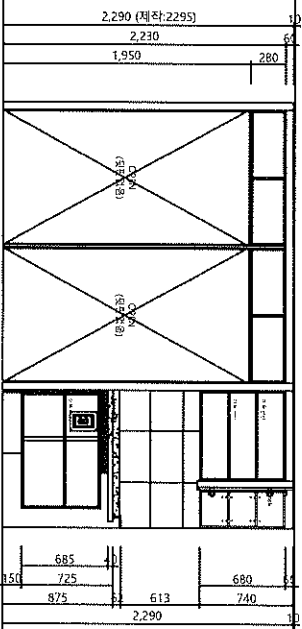

345 30 525 900(바탕) 150 1.070

도면	도판	합계
123	107	230

내부 입면도-B



3.310

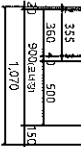
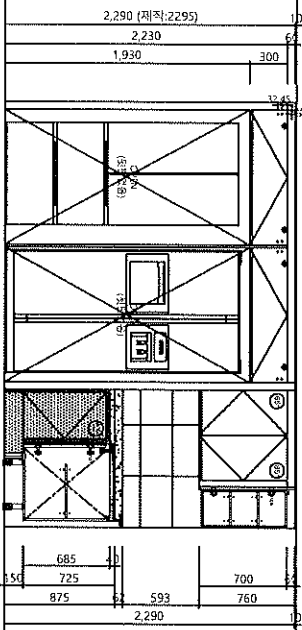

355 30 500 900(바탕) 150 1.070

도면	도판	합계
123	107	230

입면도-B

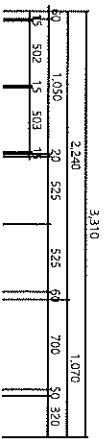

3.310

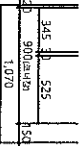
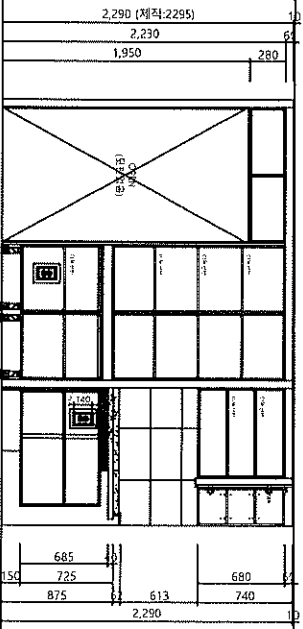

345 30 525 900(바탕) 150 1.070

DATE	2022. 09. 28	SCALE	1:1, 1:25
DESIGNER	김민준	CHECKER	김민준
DRAWER	김민준	DATE	2022. 09. 28

PROJECT NO

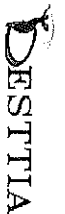

베스티아주식회사

서울시 영등포구 영등포동 11가 34번 4층 E&E702호  
TEL 02790-0381 / FAX 02790-0391

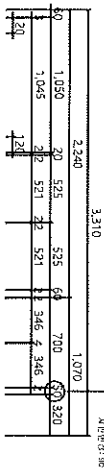

3.310

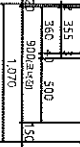
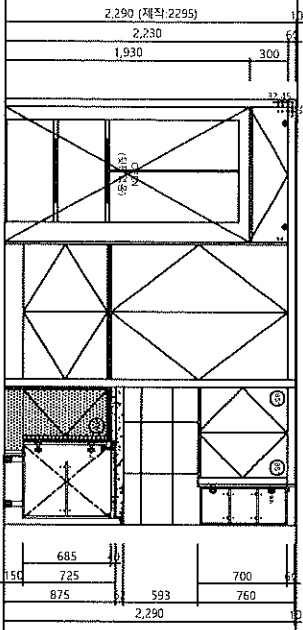

355 30 500 900(바탕) 150 1.070

도면	도판	합계
3	3	6

입면도-B (유선물선 키 큰수납장)

내부 입면도-B (유선물선 키 큰수납장)

