

20. 11. 10 수정내용

1. 가스배관장 W420 → 370
2. 조리대장 W230 → 180
3. 상부코너장 W760 → 750
4. 남창고 측 S.R.(주방 쪽) 노출면 깊이 670 → 700

계	도대	도반	분점
25	19	6	1분점
30	25	5	2분점
14	10	4	3분점
69	54	15	

생산의뢰도면
 (SH / MH / 본업)

NAME OF WORK
 75㎡ A형 (확장형)
 주방가구 평면도
 (기본기준용)

PROJ. NO.	DATE	DRAWING BY	CHECKED BY	APPROVED BY	DRAWING NO.
	2020. 10. 28	홍윤정	이시화		KF-75A-02

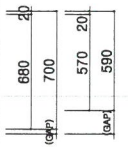
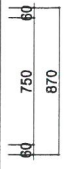
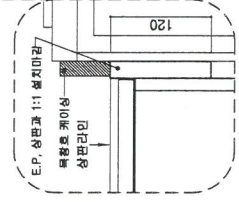
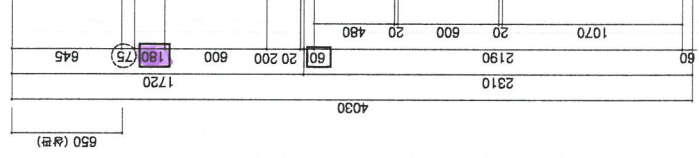
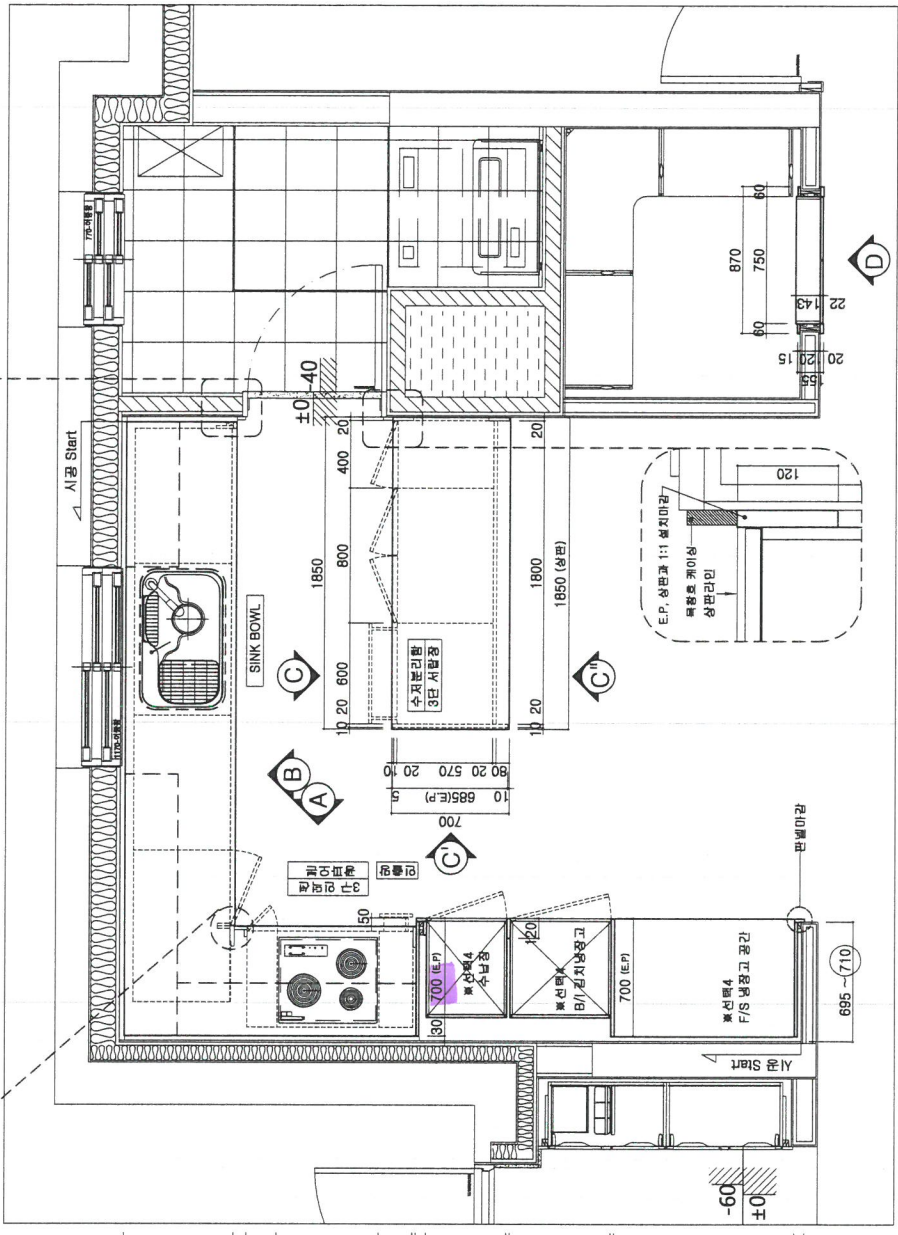
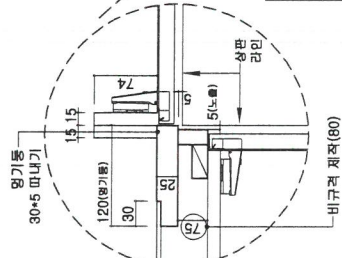
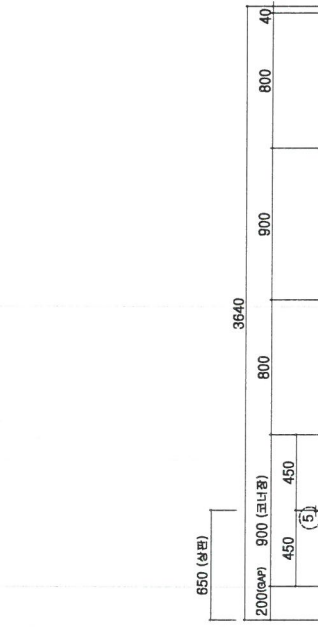
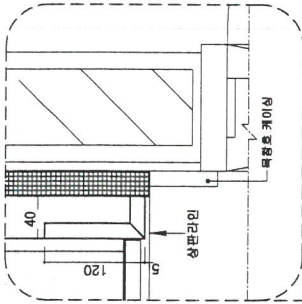

※ 아일랜드장 바닥 마감 후 시공

※ 기본형세대

개	도대	도반	분결
25	19	6	1분결
30	25	5	2분결
14	10	4	3분결
69	54	15	

※ 유상용세대

개	도대	도반	분결
15	11	4	1분결
11	5	6	2분결
6	5	1	3분결
32	21	11	

생산의뢰도면 (SH / MH / 본업)

75㎡ A형(확장형) 주방기구 인면도 (기본+유상용선기준층)

2020. 10. 28

황윤진 (인)

이시희 (인)

(인)

KF-75A-03

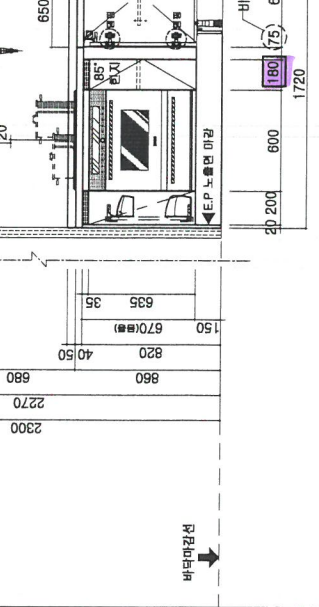
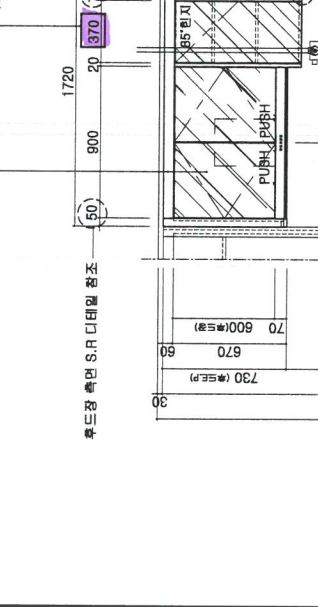
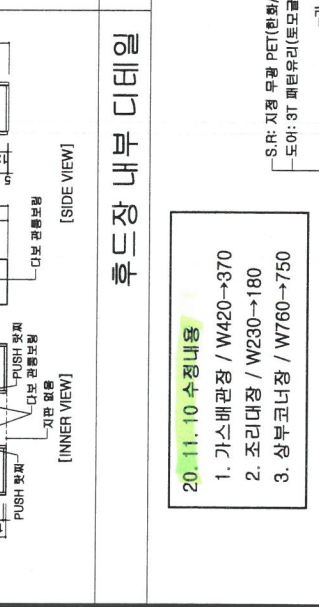
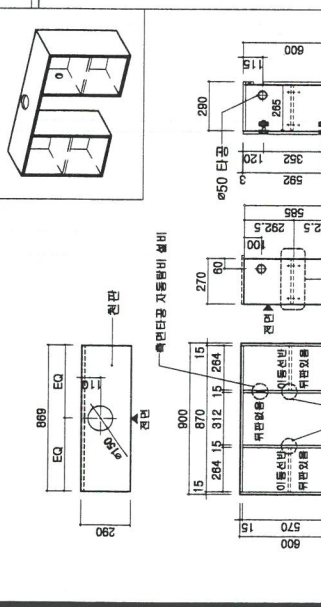
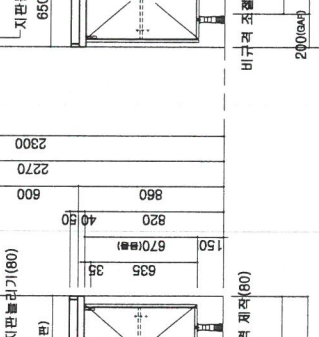
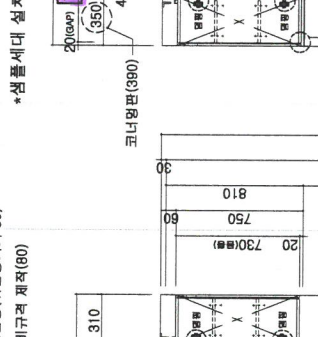
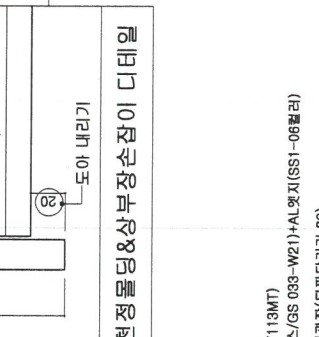
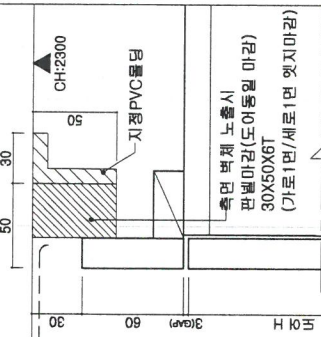
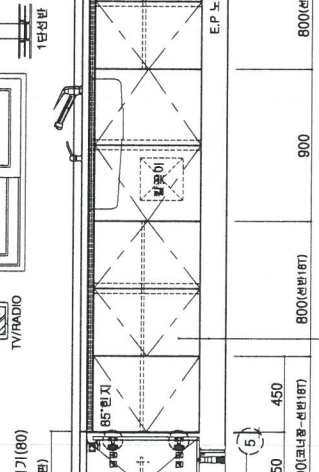
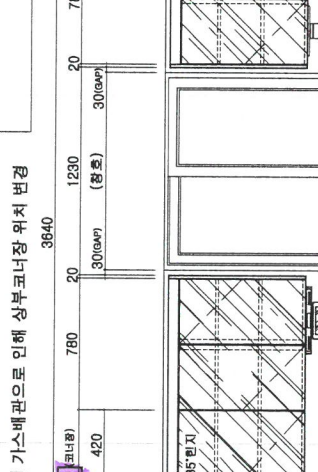
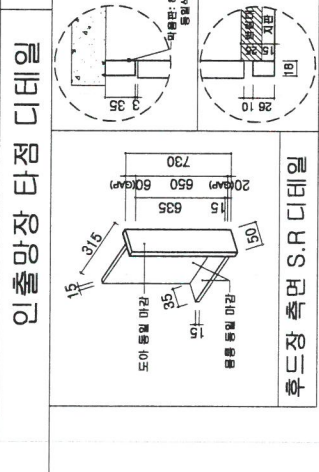
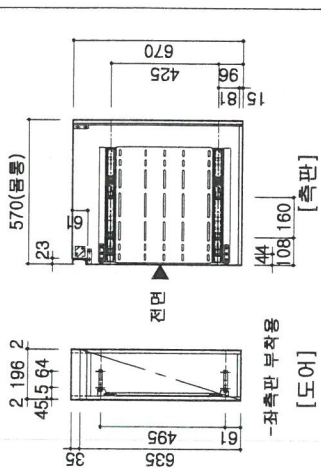
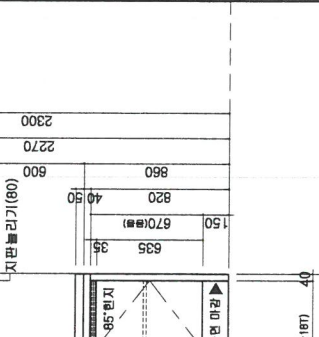
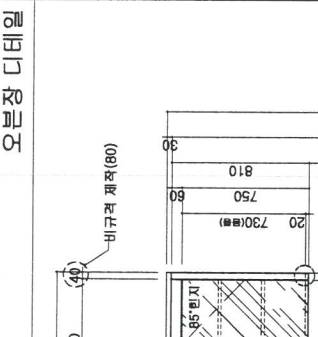
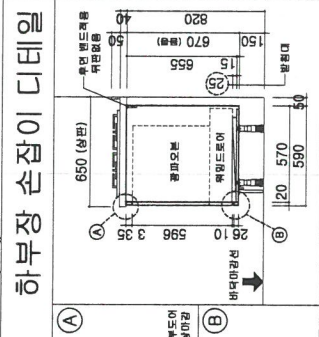
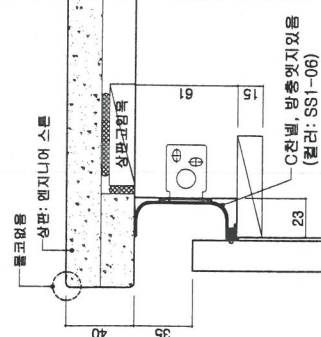

인출망장 타점 디테일

하부장 손잡이 디테일

후드장 내부 디테일

- 20.11.10 수정내용
1. 가스배관장 / W420→370
 2. 조리대장 / W230→180
 3. 상부코너장 / W760→750

오븐장 디테일

후드장 측면 S.R 디테일

천정몰딩&상부장손잡이 디테일

후드장 내부 디테일

후드장 내부 디테일

*실플세대 설치시 가스배관으로 인해 상부코너장 위치 변경

ELEVATION-A

ELEVATION-B

